

TENT INSTRUCTIONS  
13' X 16'



**PACKING LIST:**

1. TENT
2. ROPES (TIED TO TENT)
3. TEN STAKES (IN TENT BAG)
4. 12 ANGLES

**SETUP DIRECTIONS:**

1. CLEAR A FLAT AREA
2. LAY A GROUND TARP (OPTIONAL BUT HELPS KEEP THE TENT CLEAN)
3. ASSEMBLE RAFTER SYSTEM (SEE DIAGRAM BELOW)
4. INSTALL LEGS ON ONE SIDE (THIS KEEPS FRAME LOW ENOUGH TO INSTALL CANVAS)
5. PUT CANVAS ONTO FRAME (ZIPPER AND CORNERS SHOULD BE OPEN)
6. ADJUST CANVAS TO ALIGN WITH FRAME AND FASTEN STRAPS TO THE RIDGE POLES FROM INSIDE TENT.
7. INSTALL LEGS ON THE OTHER SIDE (LIFTING AND INSTALLING LEG POLES IS BEST DONE WITH TWO PEOPLE)
8. VELCRO AND TIE ALL CORNERS
9. ADJUST THE CANVAS ON FRAME AND FASTEN ALL THE STRAPS TO THE FRAME
10. TUCK GROUND CLOTH INSIDE UNDER SIDE POLES (MAKE SURE POLES HAVE PLUGS ON THE BOTTOM SO THEY DON'T PUNCTURE THE CANVAS).
11. STAKE AND TIGHTEN ROPES (MAKE SURE THERE IS NOT TOO MUCH TENSION ON ZIPPER AND ALWAYS STAKE YOUR TENT EVEN WHEN SETTING UP YOUR TENT AT HOME)

**MATERIALS NEEDED IF MAKING YOUR OWN FRAME:**

TO COMPLETE YOUR FRAME, YOU WILL NEED 1" EMT (ELECTRICAL CONDUIT) THAT CAN BE PURCHASED AT MOST HARDWARE STORES IN 10 FT SECTIONS. YOU WILL NEED TO PURCHASE TWENTY-ONE 10 FT SECTIONS.

NAME	QTY	LENGTH
RAFTER	8	7'-5"
COMMON POLE	9	5'-4 1/2"
LEG	8	4'-9"

**ADDITIONAL FRAME INFORMATION:**

IF MAKING YOUR OWN FRAME, WE RECOMMEND USING POLE CLIPS (SOLD SEPARATELY) ON THE COMMON POLES TO HELP WITH ASSEMBLY. DRILL A ¼" HOLE 1-3/4" FROM THE END OF THE CONDUIT. MAKE SURE EACH END OF THE POLE ALIGNS WITH EACH OTHER. DRILL ONE SIDE, INSTALL POLE CLIP, AND THEN CLIP IT INTO AN ANGLE CONNECTOR. THIS WILL HELP ALIGN THE LOCATION FOR THE OTHER SIDE. A DRILL PRESS AND PIPE LEVEL ALSO WORKS. IF YOU WANT TO INSTALL POLE CLIPS ON THE RAFTER POLES, DRILL A ¼" HOLE 1-1/4" FROM THE END OF THE CONDUIT.

**EXTRA METAL D-RINGS:**

THERE ARE METAL D-RINGS THAT GO ALONG THE BOTTOM OF THE OUTSIDE OF YOUR TENT. THIS ALLOWS YOU TO STAKE DOWN THE WALLS. WE DO NOT SEND STAKES FOR THESE D-RINGS. WE RECOMMEND USING OUR 10" STAKES (SOLD SEPARATELY) FOR THESE LOCATIONS.

**ATTENTION:**

1. DO NOT DRAG THE TENT WHEN ASSEMBLING AND DISMANTLING. THIS MAY DAMAGE THE CANVAS.
2. WHEN WINTER CAMPING, CLEAN OFF SNOW BUILDUP. FRAMES ARE NOT DESIGNED TO HANDLE SNOW LOADS.
3. ONLY USE A WOOD STOVE PER THE MANUFACTURER'S RECOMMENDATION. ALWAYS HAVE A SPARK ARRESTOR. SPARKS WILL BURN A HOLE IN ANY TENT CANVAS. BURN HOLES CAN BE EASILY FIXED WITH A GLUE-ON PATCH.
4. CLEAN AND DRY TENT BEFORE STORING.
5. WE HIGHLY SUGGEST YOU SET UP THE TENT FOR THE FIRST TIME AT HOME BEFORE GOING INTO THE MOUNTAINS TO ASSURE YOU HAVE ALL THE PARTS NEEDED.

**STOVE JACK:**

A RUBBER GASKET IS NOT NEEDED; THE MATERIAL IS HEAT RESISTANT.

**CUSTOMER SERVICE / WARRANTY:**

PLEASE VISIT OUR WEB SITE FOR WARRANTY AND CUSTOMER SERVICE INFORMATION AT

<https://elkmountaintents.com/customer-service/>

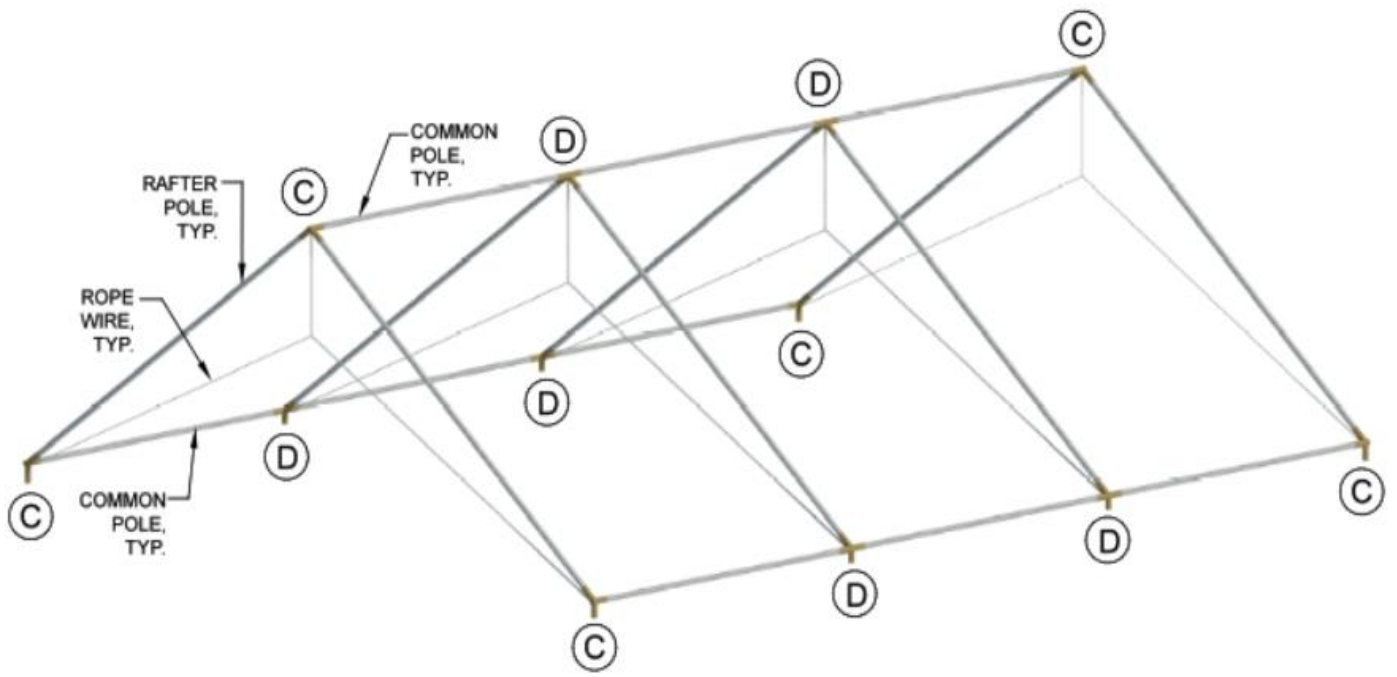

## 13' X 16' RAFTER SYSTEM

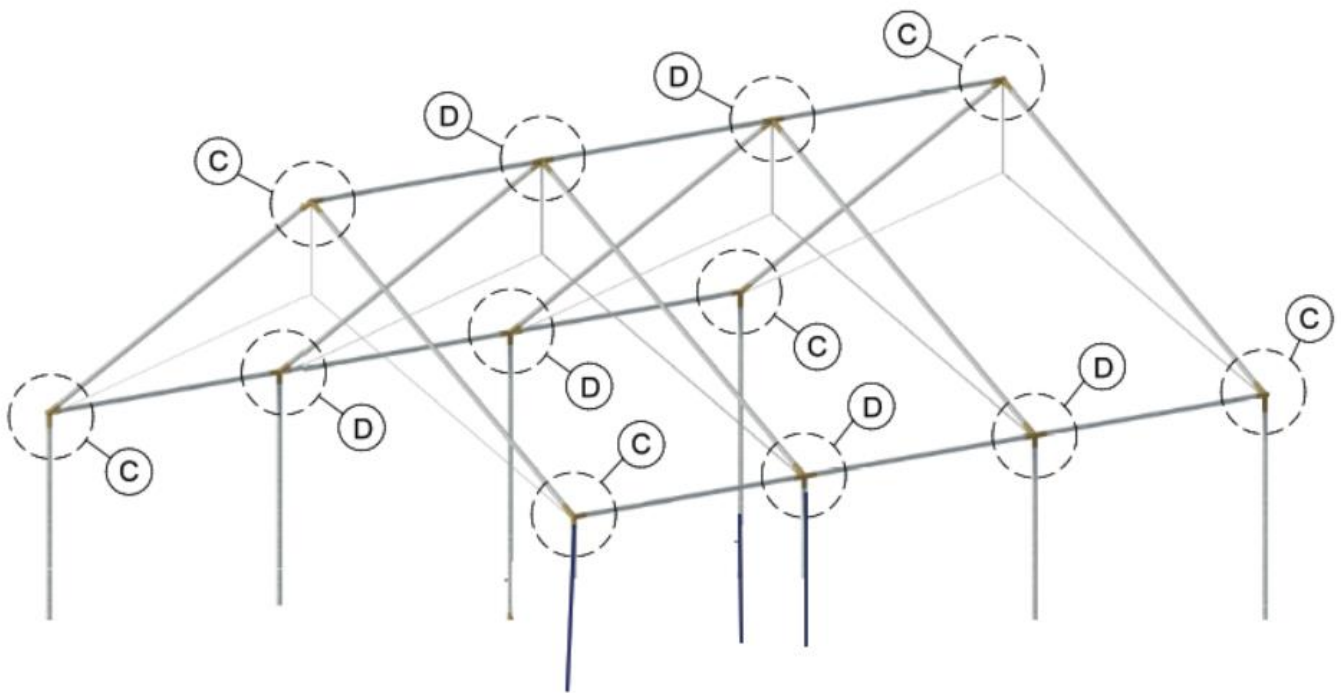

# ANGLE TO POLE CONNECTION DETAILS

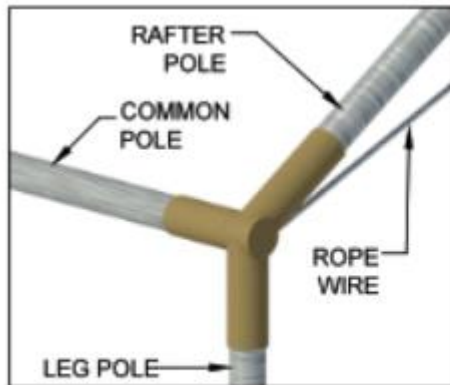

(C)

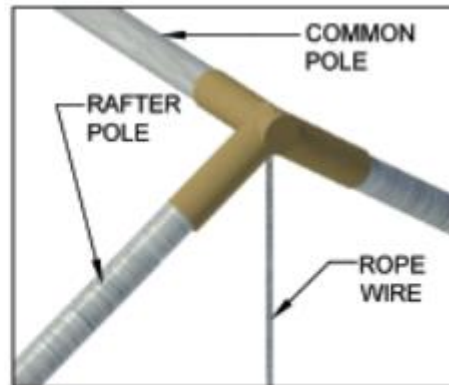

(C)

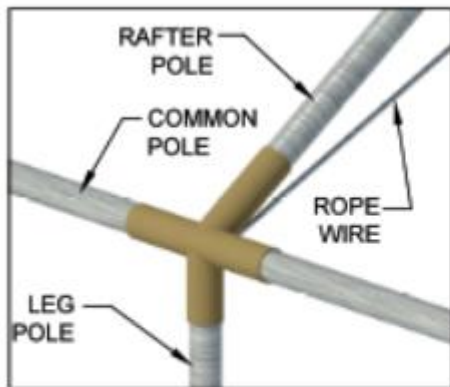

(D)

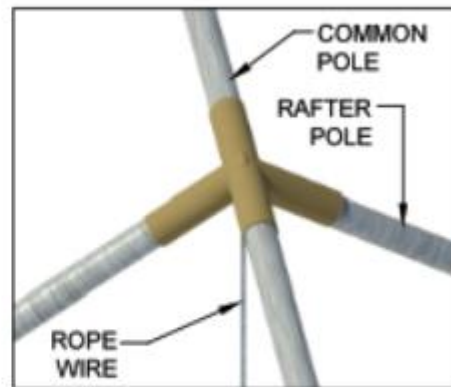

(D)

NOTE:  
THIS ANGLE CONNECTOR IS  
ALSO USED FOR AWNING  
TO TENT ATTACHMENT